

D21 - 1617 LED NEON

OUTDOOR / EXTERIOR

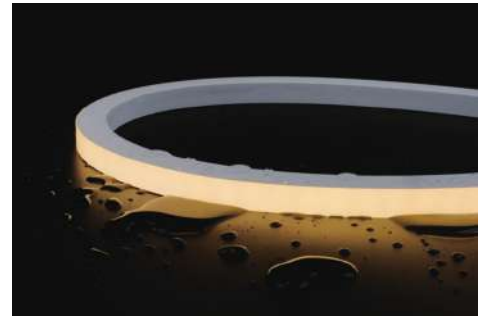

D21-1617 is a silicone co-extrusion IP67 neon that offers UV resistance, chemical stability, and protection against abrasion. It is freely configurable in length by cutting and capping with compatible endcaps.

Vertical Bending.

Up to 52ft run length from the single power feed. Dust-Free matte finish.

- Made of DOW Chemical SILASTIC™ ET-7021 silicone rubber, which provides high transparency and high strength.
- Environmental protection grade silicone material with integrated extrusion molding process.
- Unique optical light distribution structure design, uniform lighting surface and no shadow.
- IP67 protection level, resistant to salts, acids, alkalis and UV.
- Excellent toughness, simple and stylish appearance, delicate and unique.
- 5 years warranty, working life > 50000 hours.



Technical Data

Dimension	0.63in x 0.67in
Voltage	DC48V
RA	>90
Dimming	Dimmable
Efficacy	81.8LM/W @4000K
Storage Temp	-40°C ~ 60°C
Standard Length	20m
Max Length	20m
Warranty	5 Years
Watts / Meter	10 Watts
Color	3K / 45K / Static Color / RGB

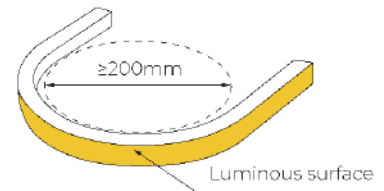

Min Bending diameter

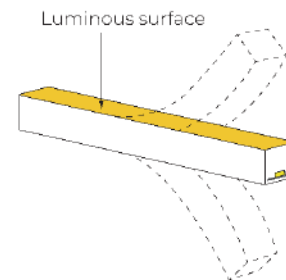

Bend vertical only

Dimensions / Structure

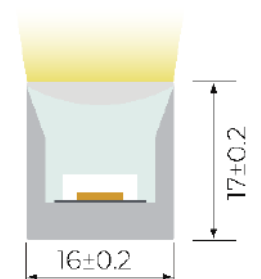
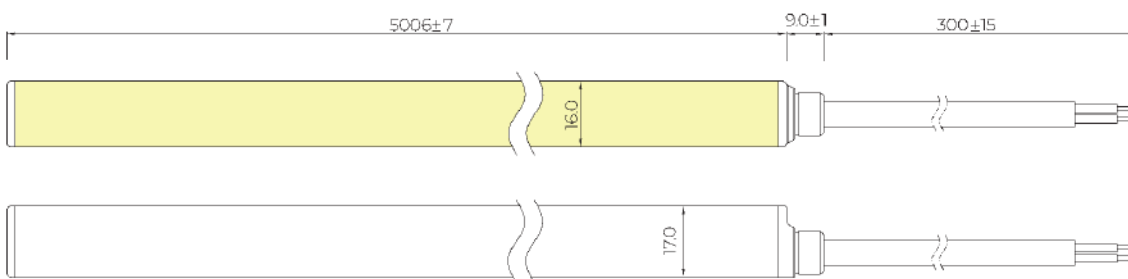

Cross section



IK10



Protection



Dirt Resistant



One Bin

3

SDCM



1ft-100ft

Factory Connectors

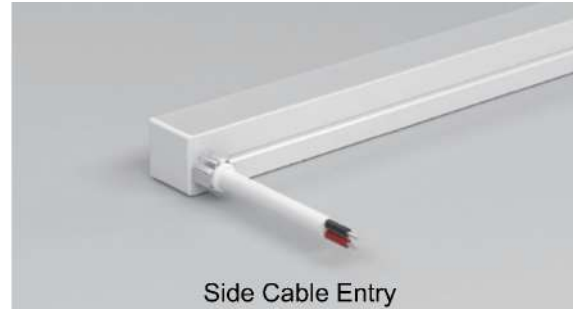
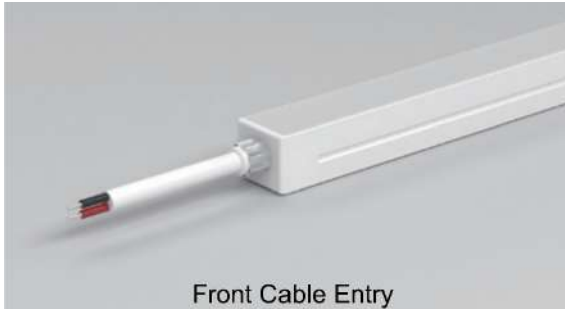

DIY Solderless Connectors

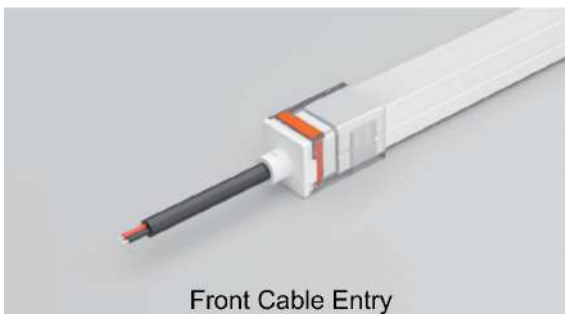

Accessories

Aluminium Mounting clips

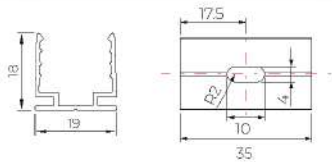

Length: 35X19X18

Accessories:

Screw M3X16 (SUS304)

PC Profile

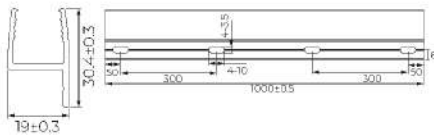

Length: 1000X19X30.4

Accessories:

Screw M3X16 (SUS304)

Aluminium Profile

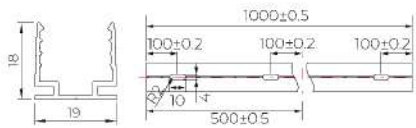

Length: 1000X19X18

Accessories:

Screw M3X16 (SUS304)

PC Profile

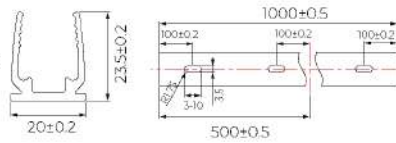

Length: 1000X20X23.5

Accessories:

Screw M3X16 (SUS304)

Internal Gear Profile

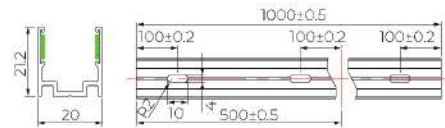

Length: 1000X20X21.2

Accessories:

Screw M3X16 (SUS304)

PC Clip

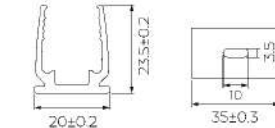

Length: 35X20X23.5

Accessories:

Screw M3X16 (SUS304)

IP67 Cross Connector

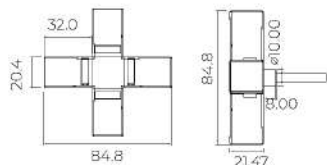

To connect 4pcs of neon after you cut it

IP67 Connector

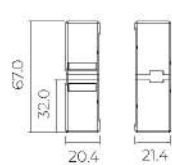

To connect 2pcs of neon after you cut it

Curved profile

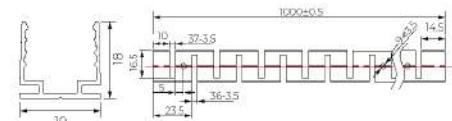
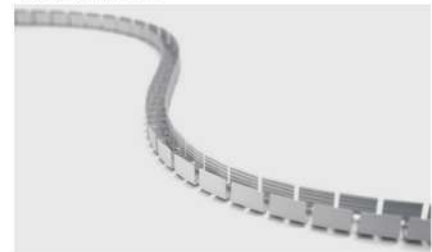

Length: 1000X19X18

Accessories:

Screw M3X16 (SUS304)

Single Colour Connection

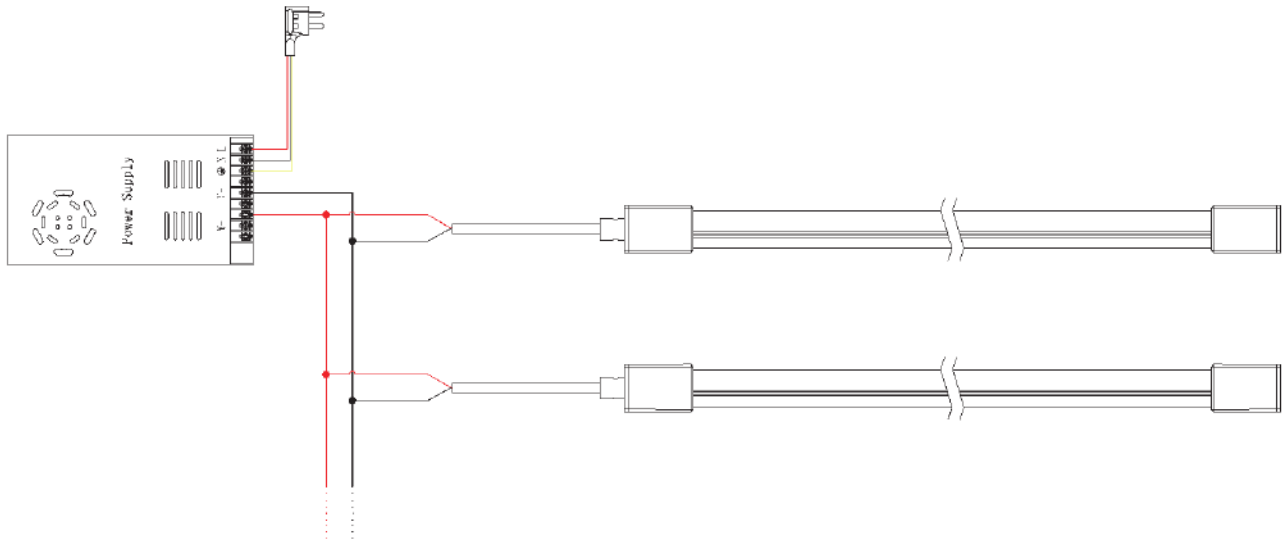

Tunable White Connection

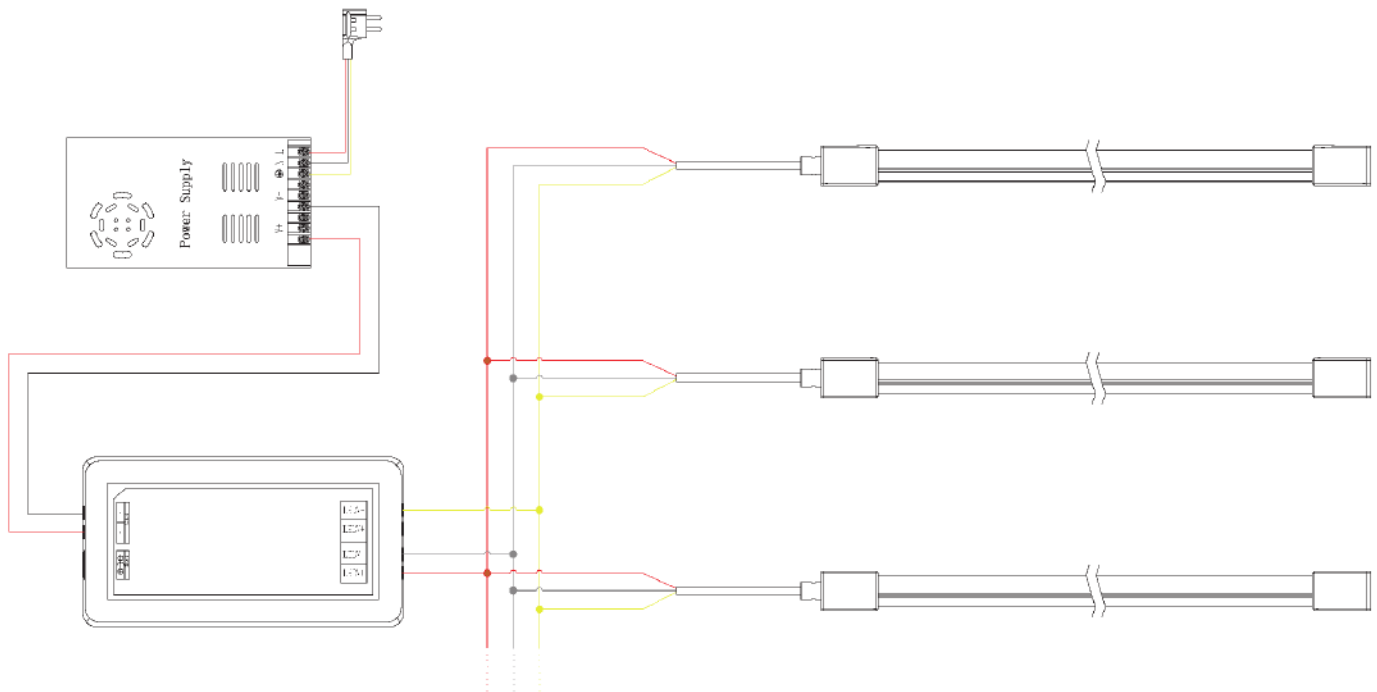

RGB Connection

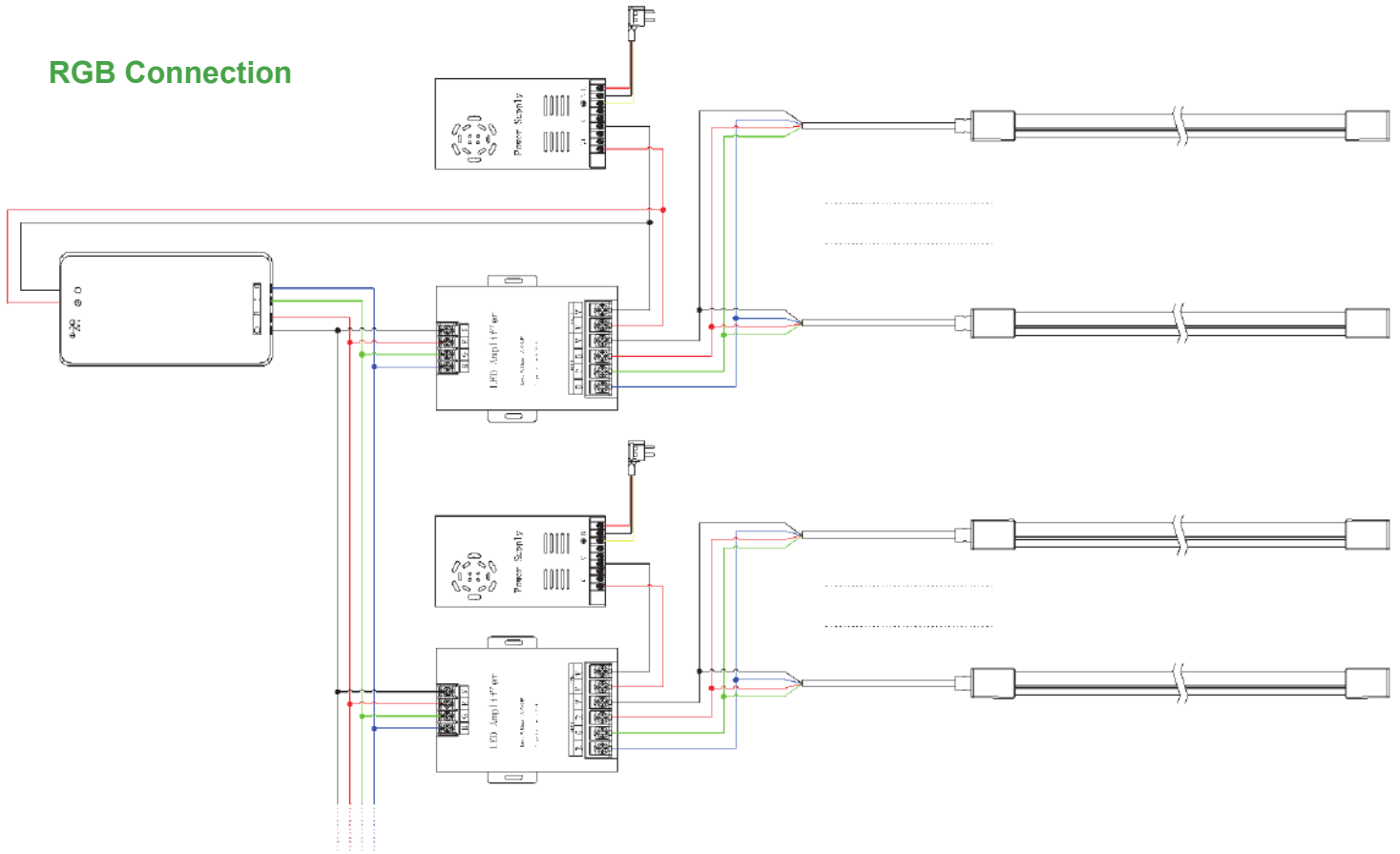

RGBW Connection

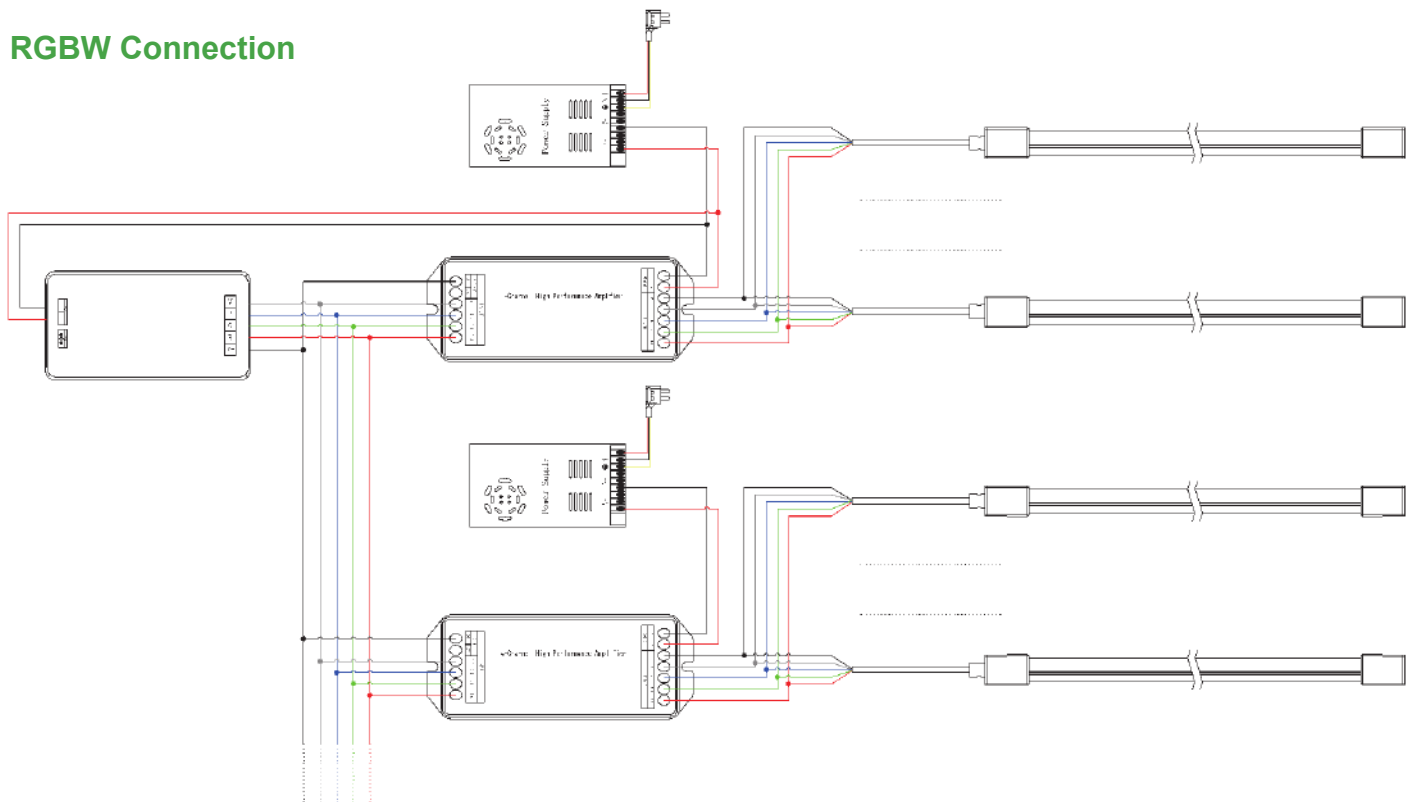

Installation Precautions

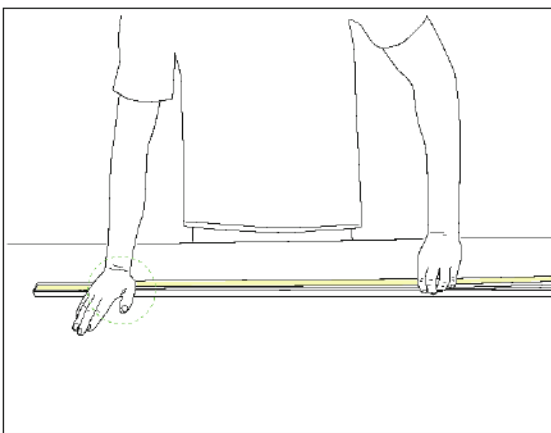
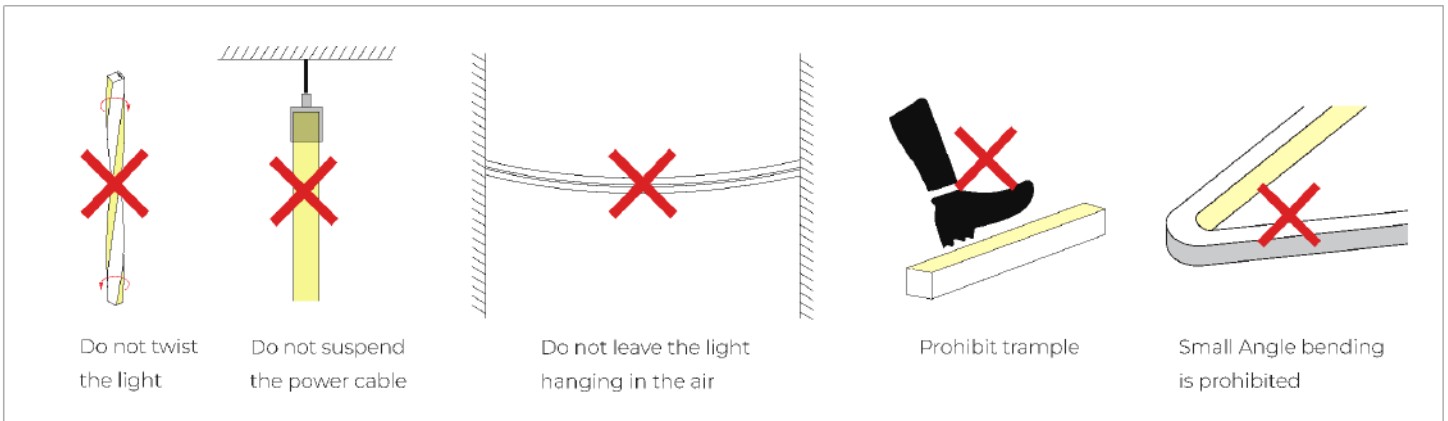
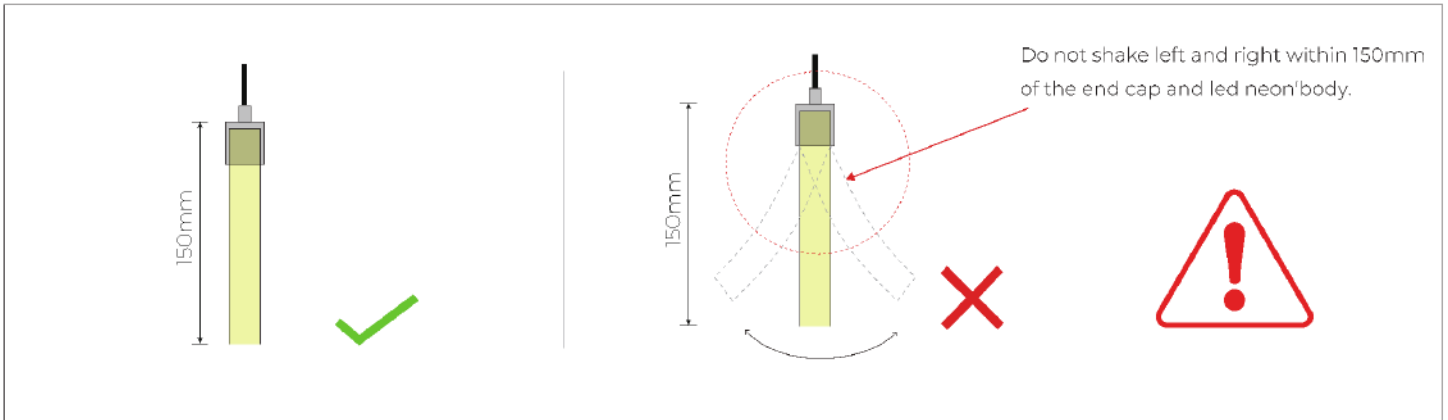

- Please press the led strip with your palm to slowly insert the led strip into the groove, and gently straighten the led strip above the groove with your right hand.
- Try to keep the led strip in a flat state during the installation process.

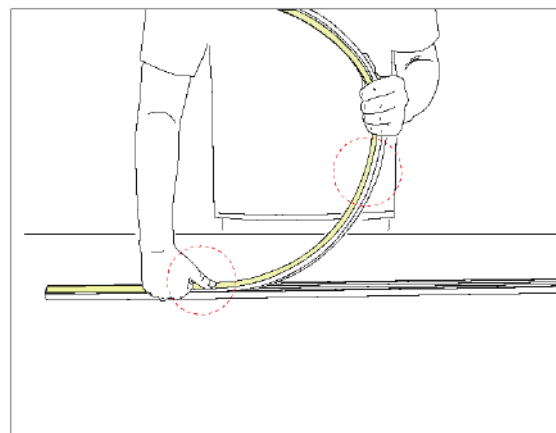

- Do not press the led strip with a single finger, it is easy to damage the internal parts of the led strip.
- The bent arc of the led strip should not be too large during installation.

Installation Precautions

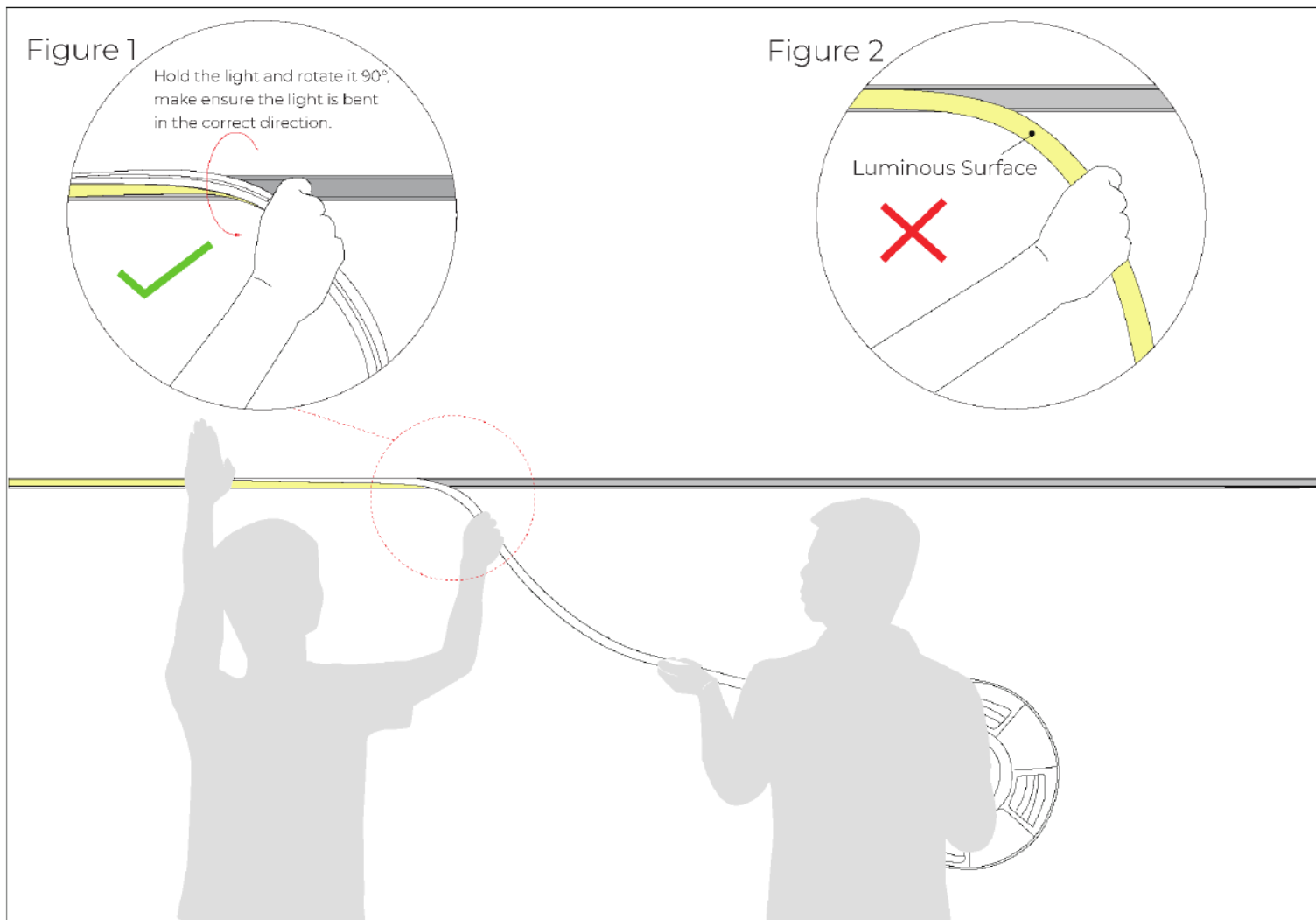

1.Installer:

-Press the light with the palm of the left hand to slowly load it into the slot. Straighten the light with right hand, hold it and rotate it 90 ° to droop it in the direction of your hand. See Figure 1.

-Do not bend the luminous surface to the side. See Figure 2.

2.Assistant:

-Cooperate with the installer to lift the reel of the light, and then slowly deliver the light to installer. Do not pull or twist the light during the installation.

Installation Precautions

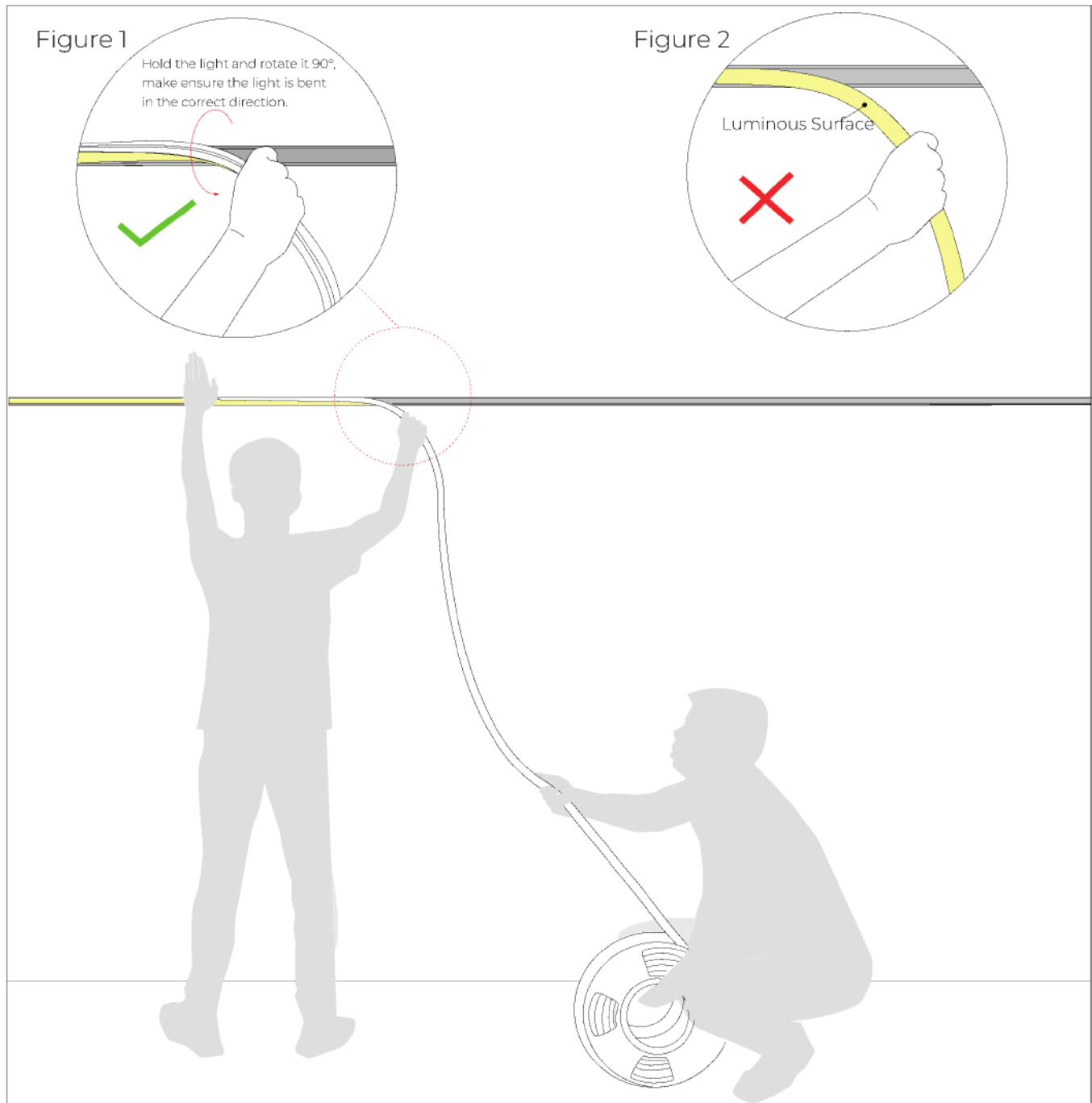

1.Installer:

-Press the light with the palm of the left hand to slowly load it into the slot. Straighten the light with right hand, hold it and rotate it 90 ° to droop it in the direction of your hand. See Figure 1.

-Do not bend the luminous surface to the side. See Figure 2.

2.Assistant:

-Cooperate with the installer to slowly deliver the light to installer. Do not pull or twist the light during the installation.

Installation Precautions

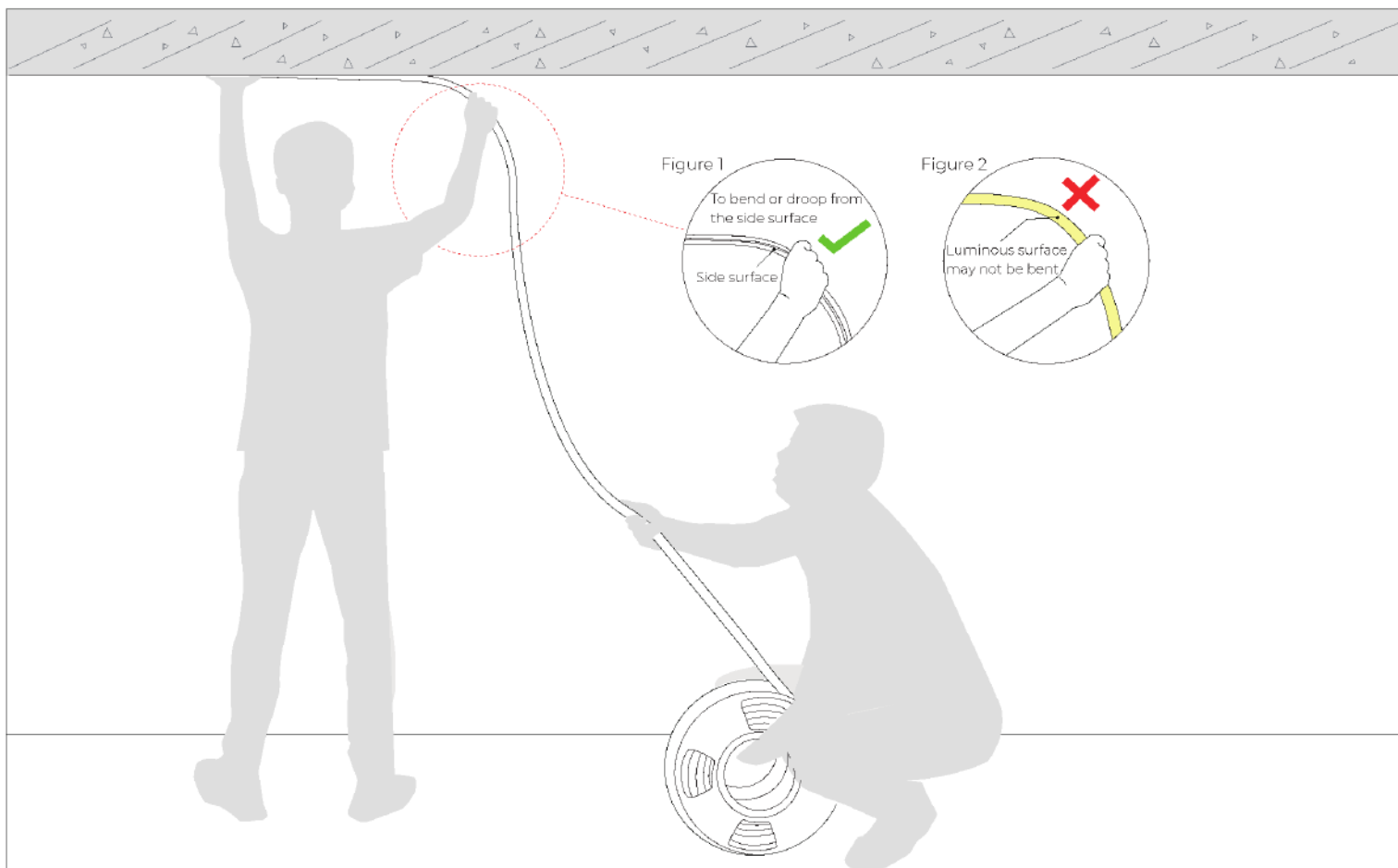

1.Installer:

- Press the light with the palm of the left hand to slowly load it into the slot. Straighten the light with your right hand so that it droop naturally. See Figure 1.
- Luminous surface may not be bent. See Figure 2.

2.Assistant:

- Cooperate with the installer to slowly deliver the light to installer. Do not pull or twist the light during the installation.

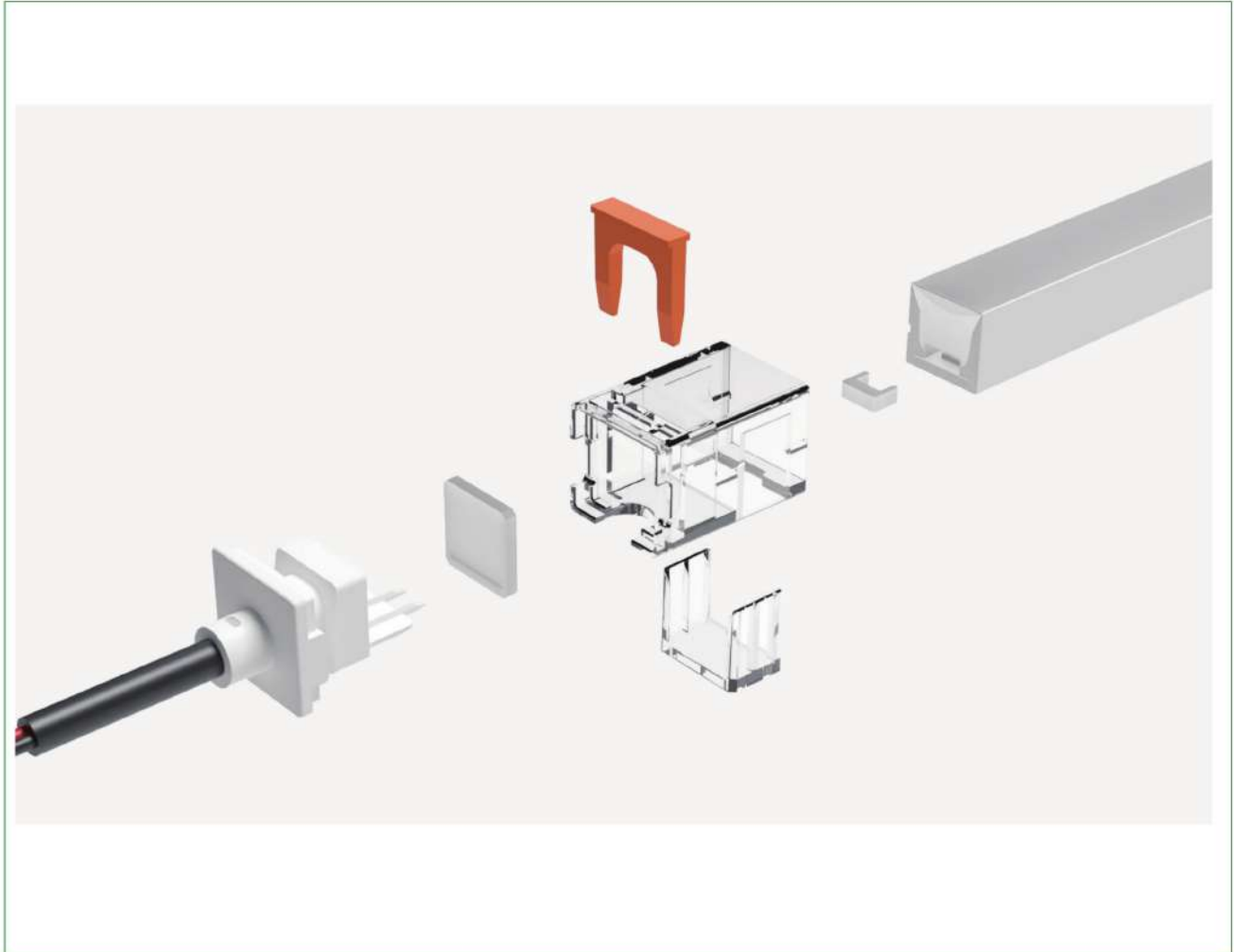

Solderless Power Feed IP67
